

NOTE:  
All vertical measurements are referenced to the top surface.

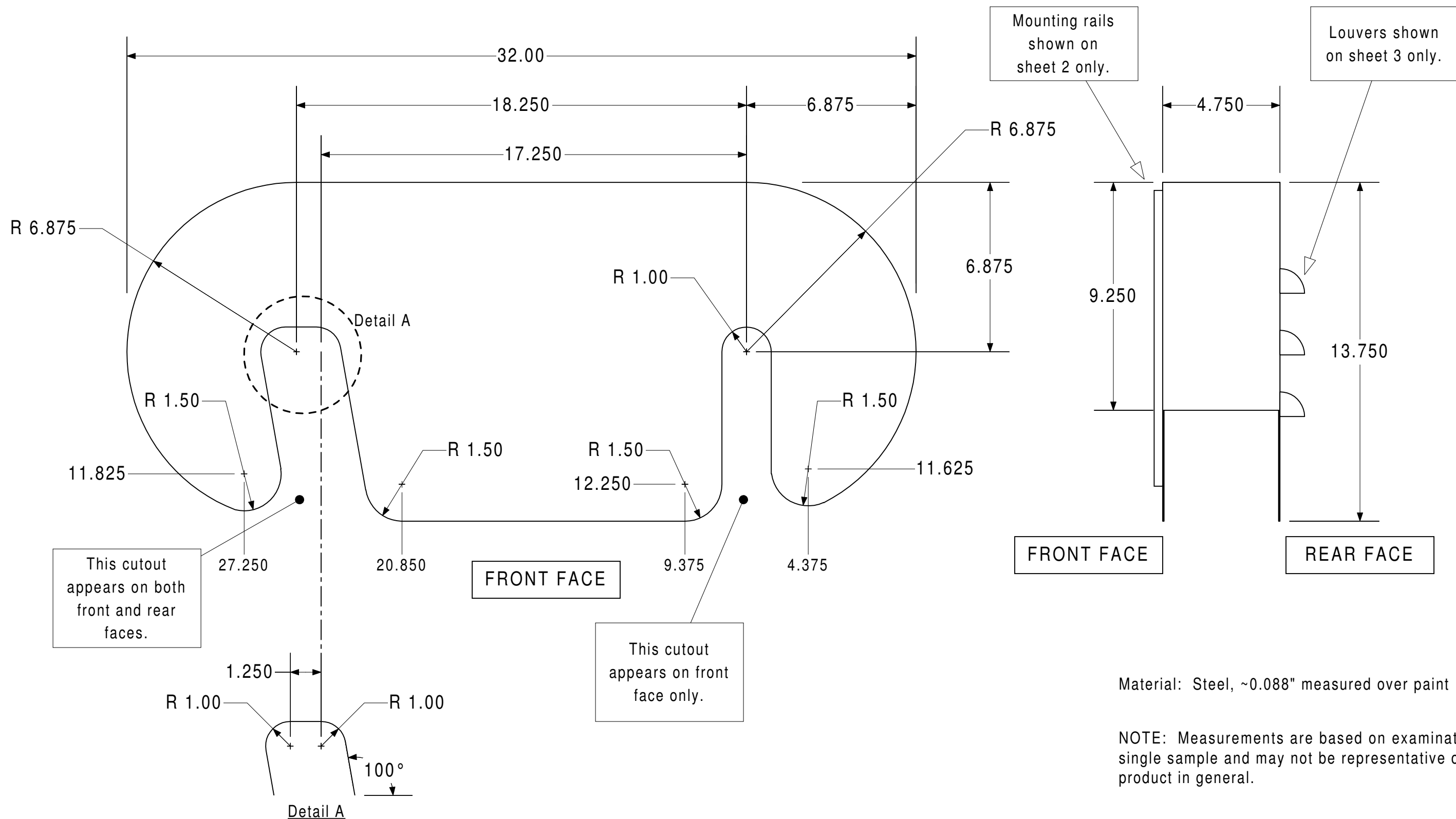

Material: Steel, ~0.088" measured over paint

NOTE: Measurements are based on examination of a single sample and may not be representative of the product in general.

		Nichols Horizontal Mill			
		Belt Cover - Front Face - Profile and Contours			
Drawn by	LB	SIZE	FSCM NO	DWG NO	REV
Date	03 JUN 2008	B			O
		SCALE	None	SHEET	1 OF 3

**NOTES:**

Positioning of the mounting rails appears to have been done by hand, with rather loose tolerances.

Rails are welded to the panel but only in a few places, not continuously.

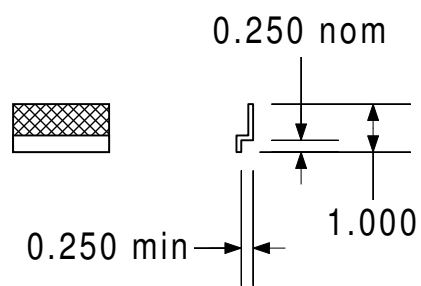
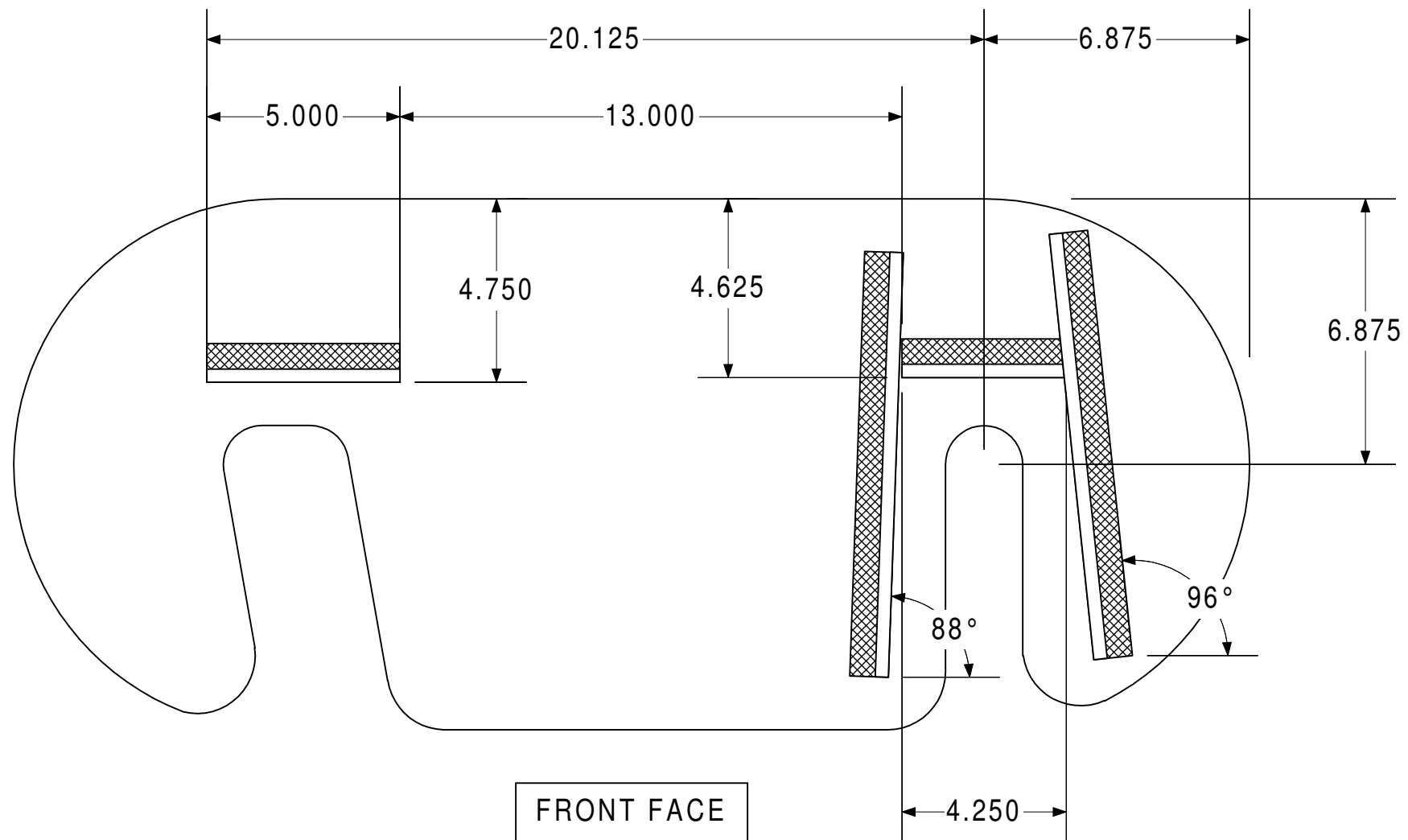

Mounting Rail Detail

Note: The 0.250" measurements are inside dimensions.

Material: Steel, ~0.088" measured over paint

NOTE: Measurements are based on examination of a single sample and may not be representative of the product in general.

		Nichols Horizontal Mill			
		Belt Cover - Front Face - Mounting Rails			
Drawn by	LB	SIZE	FSCM NO	DWG NO	REV
Date	03 JUN 2008	B			O
		SCALE	None	SHEET	2 OF 3

NOTE:  
All vertical measurements are referenced to the top surface.

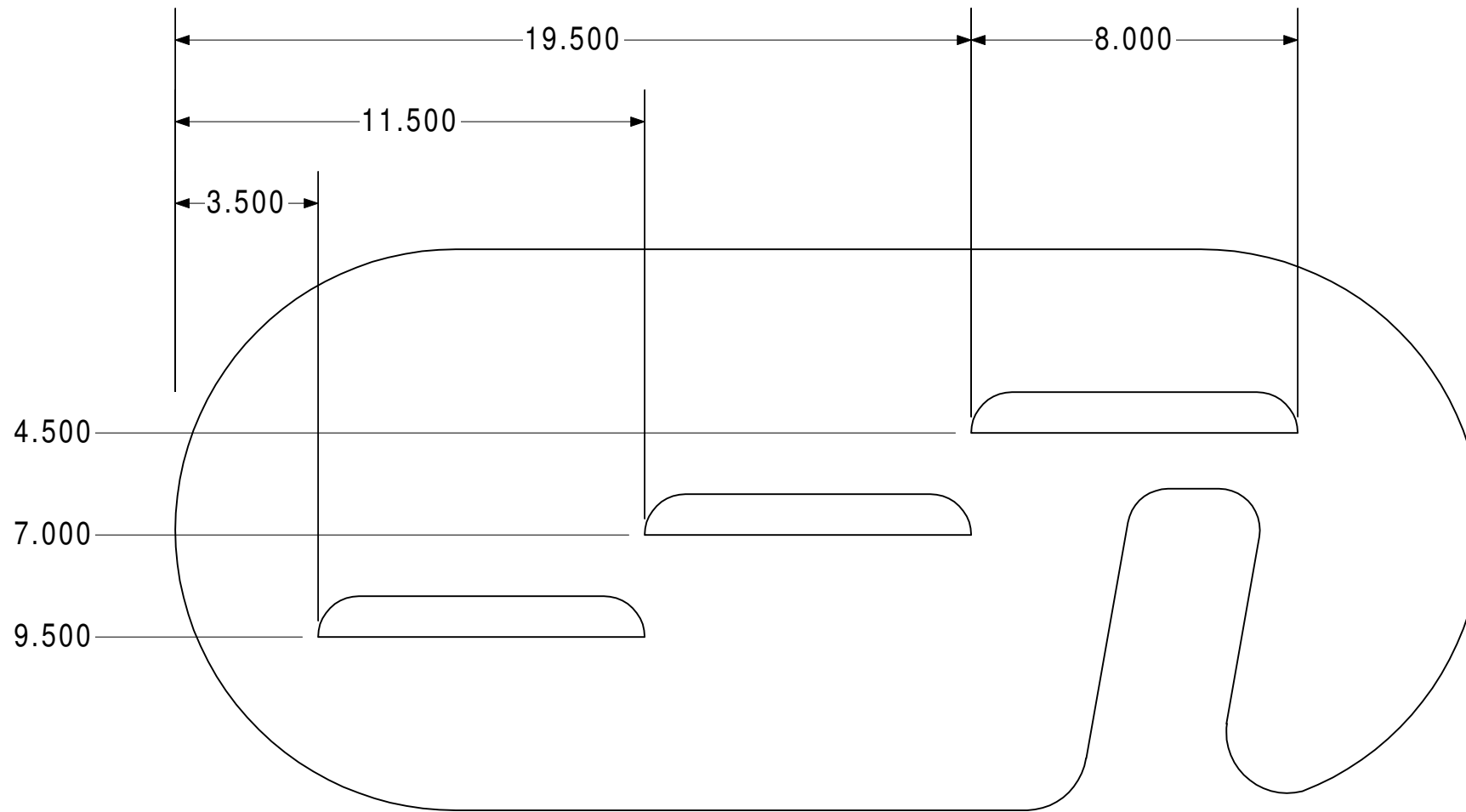

REAR FACE

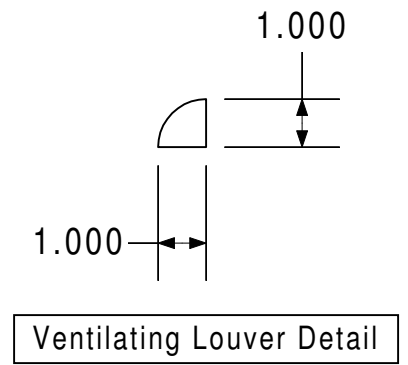

Material: Steel, ~0.088" measured over paint

NOTE: Measurements are based on examination of a single sample and may not be representative of the product in general.

		Nichols Horizontal Mill			
		Belt Cover - Rear Face - Ventilating Louvers			
Drawn by	LB	SIZE	FSCM NO	DWG NO	REV
Date	03 JUN 2008	B			O
		SCALE	None	SHEET	3 OF 3